

Power supply set (power cable + power brick)

1. Please refer to the power supply set we provide as follows.

1.1. power cable.



It is to connect with the socket (outlet).

It is to connect with the power brick.



HWASUNG
POS.KIOSK PRINTER

Hwasung System Co.,Ltd. / person in charge : Ryan H.KIM <http://www.hws-kioskprinter.com> / hwasungt@hwasungt.co.kr

Unit 604/6F,Bldg B of Digital empire,Kwan yang 906-4,Dong an,An yang,Gyeong gi,431-060,South Korea

Tel:+82-31-8086-7550 to 7553 / Fax:+82-31-8086-7555, +82:country code,31:area code

2. You can see two types of power brick as the image belows.



3pin type power brick



2pin type power brick

HWASUNG
POS.KIOSK PRINTER

Hwasung System Co.,Ltd. / person in charge : Ryan H.KIM <http://www.hws-kioskprinter.com> / hwasungt@hwasungt.co.kr

Unit 604/6F,Bldg B of Digital empire,Kwan yang 906-4,Dong an,An yang,Gyeong gi,431-060,South Korea

Tel:+82-31-8086-7550 to 7553 / Fax:+82-31-8086-7555, +82:country code,31:area code

3. You can see how they look like as the image belows- 3 pin type, and 2 pin type.

HWASUNG
POS.KIOSK PRINTER

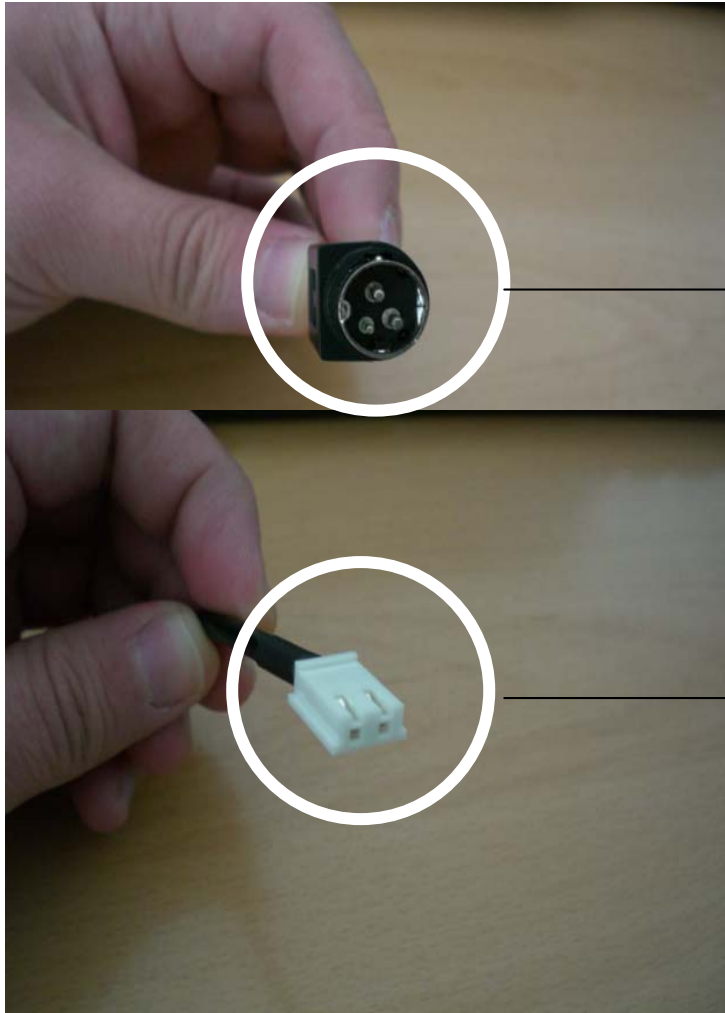

It is 3 pin type of power brick.
It is to connect with the printer.

It is 2 pin type of power brick.
It is to connect with the printer.

Notice:

Each pin type will be different with each printer.

Please make sure which pin type will be connected with the printer.

4. You can see the brief specification of power brick as the image below. The specification of power brick is the same with 3 pin type, and 2 pin type.



It is to connect with the power cable.

HWASUNG
 POS.KIOSK PRINTER

Hwasung System Co.,Ltd. / person in charge : Ryan H.KIM <http://www.hws-kioskprinter.com> / hwasungt@hwasungt.co.kr

Unit 604/6F,Bldg B of Digital empire,Kwan yang 906-4,Dong an,An yang,Gyeong gi,431-060,South Korea

Tel:+82-31-8086-7550 to 7553 / Fax:+82-31-8086-7555, +82:country code,31:area code